



For Asia Pacific Region Only

H PARTS BULLETIN

No: 97114-055
Subject: REPLACEMENT TORQUE ROD BUSHES

Date: October 2008 Revision: A

ULTRAROD – BONDED RUBBER TYPE



PART NUMBER	TYPE	"A"	"B"	"C"	"D"
47691-000-L	STRADDLE	50mm	111mm	16mm	N/A
69210-000	STRADDLE	50mm	111mm	19mm	N/A
67746-000	STRADDLE	50mm	111mm	22mm	N/A
66734-000	STRADDLE OFFSET	50mm	145mm	19mm	N/A
47692-000-L	THROUGH BOLT	50mm	75mm	22mm	N/A
65477-000	THROUGH BOLT	50mm	82mm	29mm	N/A
64697-000	TAPER	50mm	203mm	75mm	1 1/4"
64809-000	TAPER	50mm	168mm	50mm	1 1/8"
66735-000	TAPER	50mm	178mm	48mm	1 1/4"

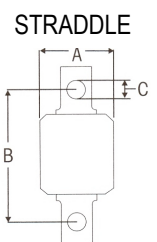

OFFSET STRADDLE

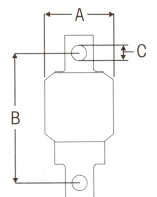

ULTRAROD PLUS – STEEL SLEEVE TYPE



PART NUMBER	TYPE	"A"	"B"	"C"	"D"
44695-000-L	STRADDLE	70mm	111mm	16mm	N/A
49210-000-L	STRADDLE	70mm	111mm	19mm	N/A
46734-000-L	STRADDLE OFFSET	70mm	145mm	19mm	N/A
46736-000-L	THROUGH BOLT	70mm	82mm	29mm	N/A
44697-000-L	TAPER	70mm	203mm	75mm	1 1/4"
46737-000-L	TAPER	70mm	168mm	50mm	1 1/8"
46735-000-L	TAPER	70mm	178mm	48mm	1 1/4"

THROUGH BOLT

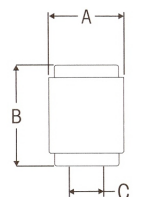

TAPER

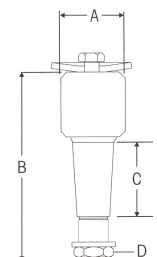

Information contained in this literature was accurate at the time of publication. Product changes may have been made after the publication date that are not reflected here