

TECHNICAL PROCEDURE INTRAAX®

SUBJECT: Shock Mount Assembly Procedure

LIT NO: L635

DATE: July 2022

REVISION: F

Hendrickson uses a shear-type bolt in the lower shock absorber connection on many suspensions. To obtain the proper clamp load, install hardened washers on each side of the shock absorber bushing (Figure 1), or install the shock strap clevis (Figure 3), and tighten the shear-type bolt until the bolt's Torx head shears off. Use an E20 Torx socket to tighten and shear the bolt. Torx head separation occurs between 220 ± 20 ft. lbs. (300 ± 15 Nm) of torque.

The upper shock mount is tightened to 225 ± 10 ft. lbs. (300 ± 10 Nm) of torque (Figure 4).

AANLS uses a hex head cap screw for the lower shock bolt. Tighten to 225 ± 10 ft. lbs. (300 ± 10 Nm) of torque.

Failure to follow these instructions could result in damage to the suspension and / or its components.

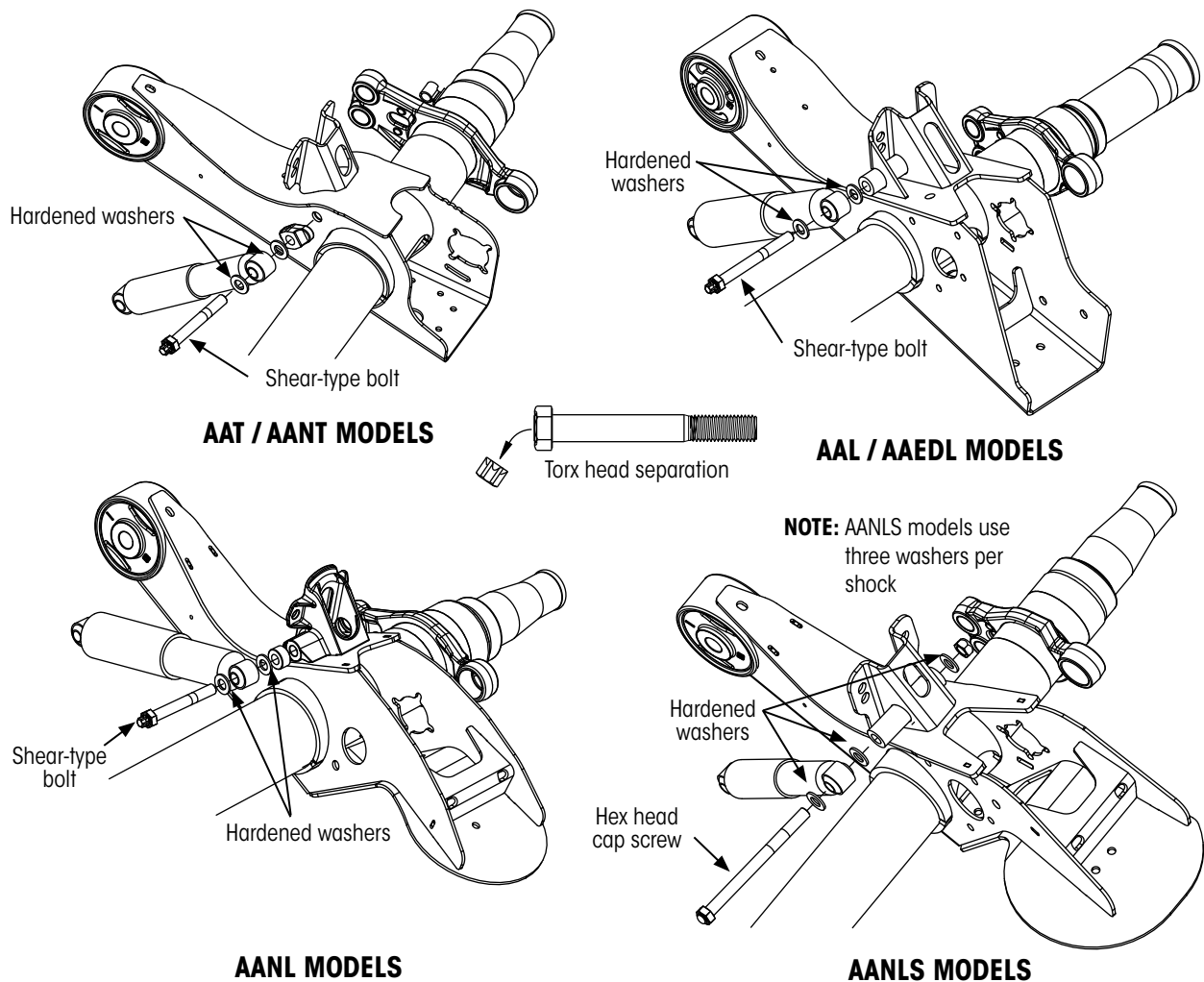

Figure 1: Lower shock mount assembly on suspensions without shock straps

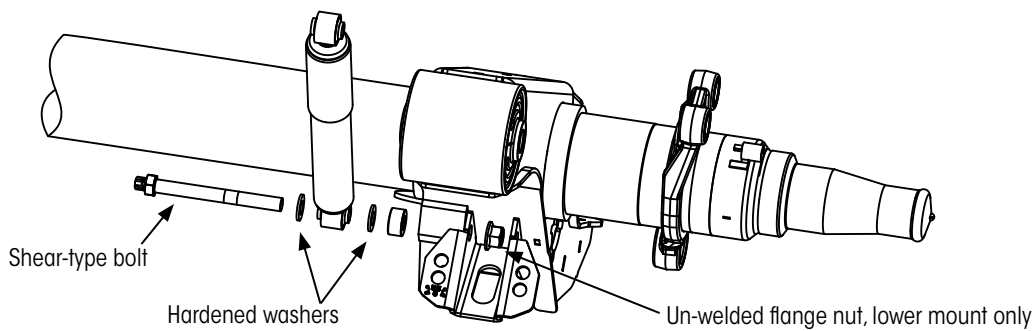

Figure 2: AAL lower shock mount with LDA axle

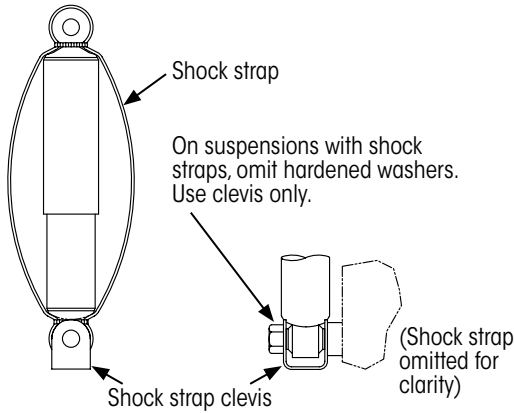

Figure 3: Lower shock mount assembly on suspensions with shock straps

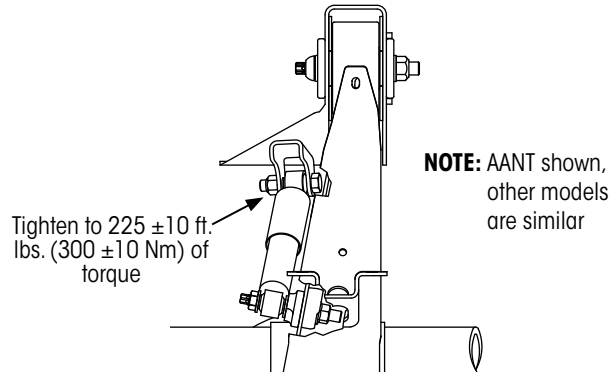

Figure 4: Upper shock mount assembly

If the nut on the inside of the suspension beam is damaged or cannot be reused (i.e., threads are stripped, nut is cracked, etc.), drill out the threads in the lower shock mounting block inside the suspension beam (Figure 5) and use the extra washer and nut provided in the shock bolt service kit to complete the lower shock mount.

For more details on AAT, AANT or AAL, AAEDL, AAEDT and AANLS model shock mount repair contact Hendrickson Technical Services in the United States and Canada at 866-RIDEAIR (743-3247) or in Mexico at +52 (442) 296-3600.

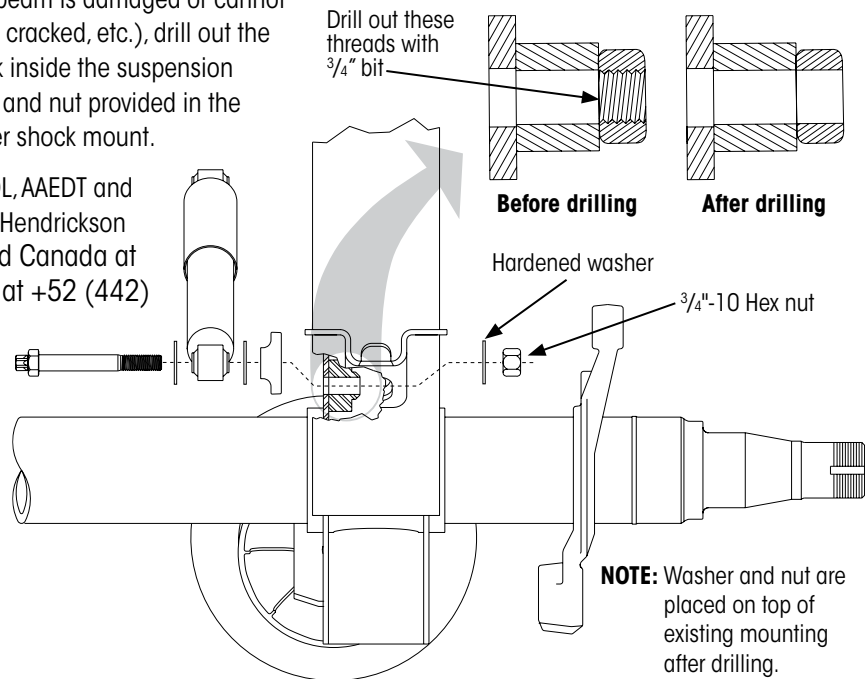

Figure 5: Damaged thread hardware assembly

Actual product performance may vary depending upon vehicle configuration, operation, service and other factors.

Call Hendrickson at **866.RIDEAIR (743.3247)** for additional information.



www.hendrickson-intl.com

TRAILER COMMERCIAL VEHICLE SYSTEMS
 2070 Industrial Place SE
 Canton, OH 44707-2641 USA
 866.RIDEAIR (743.3247)
 Fax 800.696.4416

Hendrickson Canada
 2825 Argenta Road, Unit #2-4
 Mississauga, ON Canada L5N 8G6
 800.668.5360
 905.789.1030 • Fax 905.812.9423

Hendrickson Mexicana
 Circuito El Marqués Sur #29
 Parque Industrial El Marqués
 Pob. El Colorado, Municipio El Marqués,
 Querétaro, México C.P. 76246
 +52 (442) 296.3600 • Fax +52 (442) 296.3601

L635 Rev F 07-22 CN 039808 Rev E 2-14 ECN 22856

Information contained in this literature was accurate at the time of publication. Product changes may have been made after the copyright date that are not reflected. © 2022 Hendrickson USA, L.L.C. All Rights Reserved

Printed in United States of America