

TECHNICAL PROCEDURE

TRAILER SUSPENSION SYSTEMS ZMD® DOWN STOP

SUBJECT: Replacement Procedure
on ULTRAA-K® Slider Suspensions

LIT NO: T82005

DATE: April 2017

INTRODUCTION

ZMD® ZERO MAINTENANCE DAMPING®, standard on ULTRAA-K® slider suspension systems, includes two major components: air springs and down stops. The down stop replacement kit includes one down stop and hardware (Figure 1).

⚠WARNING: Chock or block the wheels on the trailer to prevent movement while working on the suspension components and systems. Failure to block the trailer may lead to serious injury or death.

⚠WARNING: Do not work under a trailer supported only by jacks. Jacks can slip or fall over, resulting in serious personal injury. Always use safety stands to support a raised trailer.

NOTICE: Failure to follow these instructions could result in damage to the suspension and/or its components.

For more safety and precaution statements, refer to Hendrickson literature number T12007, available at www.Hendrickson-intl.com/TrailerLit.

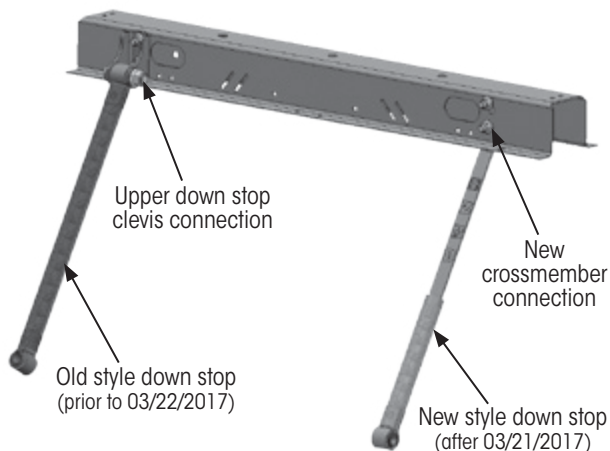

Figure 1: Down stop replacement

REMOVE ZMD® DOWN STOP

1. Disconnect the down stop from the slider.
2. If replacing an old style down stop (Figure 1), remove the upper down stop clevis from the crossmember.
3. Discard removed components and fasteners.

INSTALLING NEW ZMD® DOWN STOP

The current style ZMD down stop and hardware is provided with the kit.

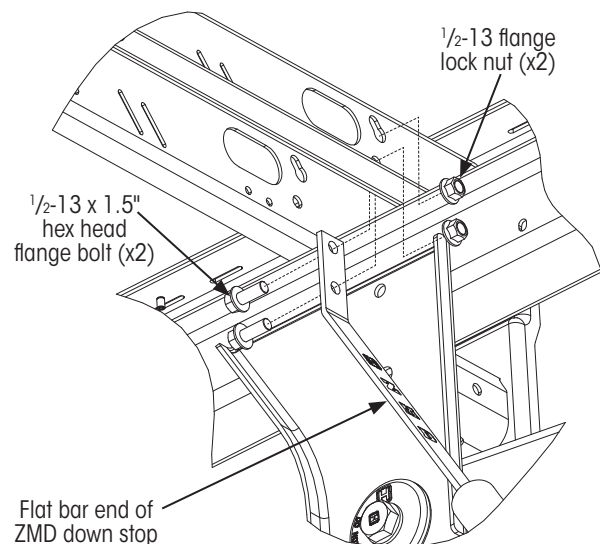

Figure 2: ZMD® Down stop mounting holes

1. Assemble metal bar end of the down stop to the inside of the slider crossmember, as shown in Figure 2, using two 1/2-13 x 1.5 flange bolts and flange nuts provided with the kit.

IMPORTANT: The bolts must be installed as shown to allow for QUIK-DRAW® clearance on front crossmember.

2. Tighten nuts to 90±10 ft. lbs. (125±10 Nm) of torque.

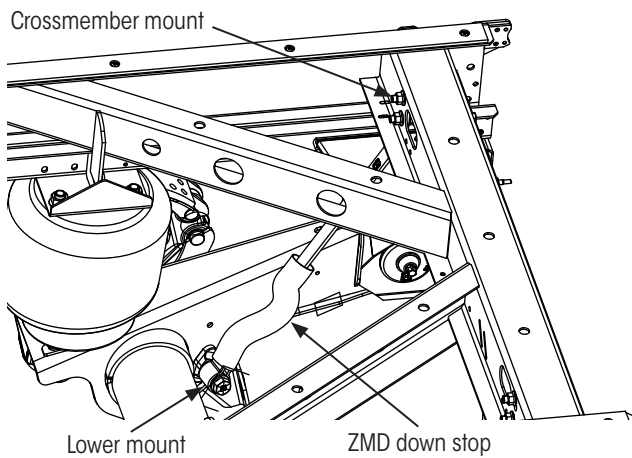

Figure 3: ZMD® Down stop mounting to existing mount

3. Using the hardware provided with the kit, **slide** a hardened washer onto the shear-type bolt (Figure 2).
4. **Insert** the shear-type bolt through the lower eyelet of the down stop.
5. **Slide** the second hardened washer onto the shear-type bolt.

6. **Thread** the shear-type bolt into the lower shock mount nut as shown in (Figure 2) and hand tighten.

NOTE: For the suspension beam lower shock mount, the nut is tack welded inside the beam (Figure 2). If the threads are damaged and the nut is not reusable, refer to L635 INTRAAX® Shock Mount Assembly Procedure.

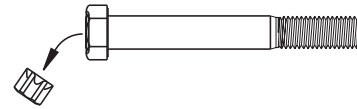

Figure 4: Shear bolt Torx head separation

7. Use an E20 Torx® socket to **tighten** the shear-type bolt until the bolt's Torx head shears off, as shown in Figure 4.
8. **Repeat** this procedure for the other down stops as needed.

For further assistance or any questions, please contact **Hendrickson Trailer Technical Services**, in the United States and Canada at 866-RIDEAIR (743-3247) or email HTTS@Hendrickson-intl.com.

Call Hendrickson at **866.RIDEAIR (743.3247)** for additional information.



www.hendrickson-intl.com

TRAILER COMMERCIAL VEHICLE SYSTEMS
 2070 Industrial Place SE
 Canton, OH 44707-2641 USA
 866.RIDEAIR (743.3247)
 330.489.0045 • Fax 800.696.4416

Hendrickson Canada
 250 Chrysler Drive, Unit #3
 Brampton, ON Canada L6S 6B6
 800.668.5360
 905.789.1030 • Fax 905.789.1033

Hendrickson Mexicana
 Circuito El Marqués Sur #29
 Parque Industrial El Marqués
 Pob. El Colorado, Municipio El Marqués,
 Querétaro, México C.P. 76246
 +52 (442) 296.3600 • Fax +52 (442) 296.3601