

PARTS LIST

SERVICE TOOLS

LIT NO: L720

DATE: April 2019

REVISION: D

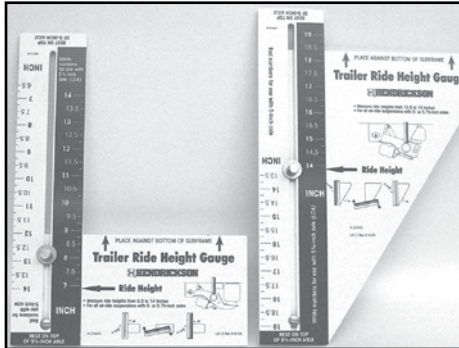

RIDE HEIGHT GAUGE

Part No. A-23442

Used to measure ride heights from 13.5" to 19" on any Hendrickson top-mount suspension with 5" or LDA™ Large Diameter Axle.

Part No. A-23445

Used to measure ride heights from 6.5" to 14" on any Hendrickson low-ride suspension with 5" or LDA Large Diameter Axle.

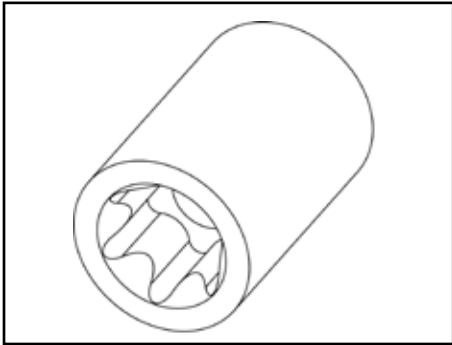

E-20 SOCKET

Part No. S-24303 (3/4" drive)

S-24536 (1" drive)

S-25119 (1" drive with sleeve)

Used for the QUIK-ALIGN® pivot connection to install the shear-type bolt through the collars.

Used to install the lower shock mount on INTRAAX®, VANTRAAX® and HT™ SERIES HT250US models.

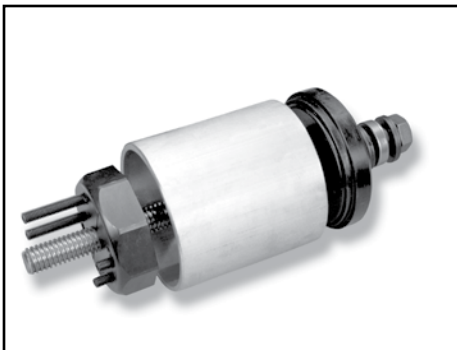

TRI-FUNCTIONAL® BUSHING TOOL

Part No. S-21307 (TRI-FUNCTIONAL Bushing I & II – 6.75" wide)

S-24736 (TRI-FUNCTIONAL Bushing III – 3.625" wide)

Used to remove and replace TRI-FUNCTIONAL Bushings.



TRI-FUNCTIONAL® BUSHING TOOL LUBE

Part No. S-21337 (extreme pressure lube)

Used on hex-head bolt, thrust bearing and thrust washers of the TRI-FUNCTIONAL Bushing Tool.

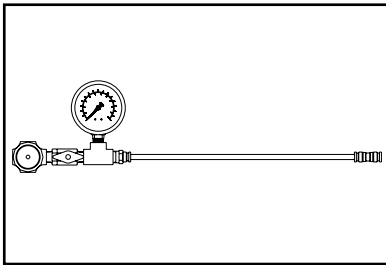

TIREMAAX® EC PRESSURE TESTER
Part No. VS-28707

Provides a continuous regulated source of pressure to the system to check air fittings for leaks.

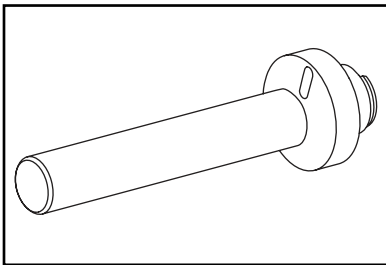

TIREMAAX PLUG DRIVER

- Part No. S-28146-1** (HN, 1.75" driver)
- S-28146-2** (HP, 2.50" driver)
- S-28146-3** (HP and HUS/P90, 2.75" driver)
- S-27399** (driver handle)

Used to insert spindle plugs to the proper depth.

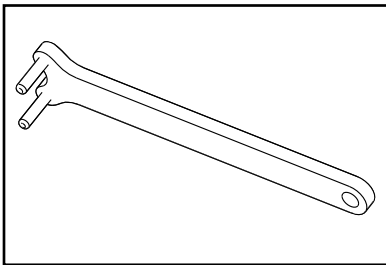

TIREMAAX SPANNER WRENCH
Part No. S-29430

Holds rotary union stationary while tightening threaded axle hose.

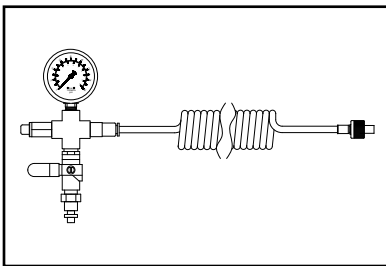

TIREMAAX PRO TARGET GAUGE
Part No. VS-32331

Provides a convenient way to check the controller delivery pressure without disconnecting any of the delivery line fittings. The flexible tube stretches to allow the gauge to be visible from the controller location while adjusting target pressure.

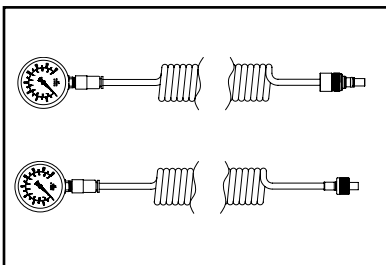

TIREMAAX CP TARGET GAUGE
Part No. VS-32344 (CP with Hubcap-Mounted Rotary Union)
VS-30468 (CP with Spindle-Mounted Rotary Union)

Provides a convenient way to check the controller delivery pressure without disconnecting any of the delivery line fittings. The flexible tube stretches to allow the gauge to be visible from the controller location while adjusting target pressure.

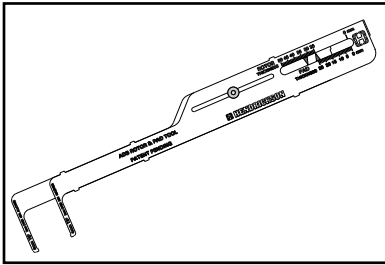
**AIR DISC BRAKE WEAR TOOL****Part No. S-37430**

Used to measure rotor and pad thickness on all air disc brake systems.

**AIR DISC BRAKE ADJUSTER TOOL****Part No. S-32676-5**

Used for air disc brake maintenance of WABCO PAN22 and Hendrickson MAXX22T™ systems.

**AIR DISC BRAKE ADJUSTER TOOL****Part No. S-38378**

Used for air disc brake maintenance of WABCO PAN22 and Hendrickson MAXX22T™ systems.

**HENDRICKSON MAXX22T™ TOOL****Part No. S-35303-6**

Used to remove and install brake components for Hendrickson MAXX22T systems.

**WABCO PAN22 TOOL****Part No. S-32676-6**

Used to remove and install brake components for WABCO PAN22 air disc brake systems.

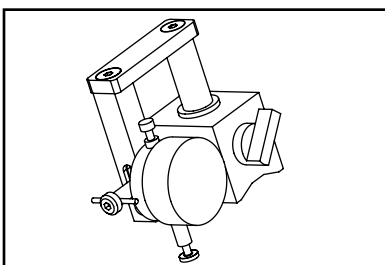
**END PLAY GAUGE****Part No. S-36710-1** (HN)**S-36710-2** (HP)**S-36710-3** (HN & HP)**S-36706** (digital indicator)

Used to measure end play for all wheel-end systems.

*Actual product performance may vary depending upon vehicle configuration, operation, service and other factors.
All applications must comply with applicable Hendrickson specifications and must be approved by the respective vehicle manufacturer with the vehicle in its original, as-built configuration.
Contact Hendrickson for additional details regarding specifications, applications, capacities, and operation, service and maintenance instructions.*

Call Hendrickson at 330.489.0045 or 866.RIDEAIR (743.3247) for additional information.



www.hendrickson-intl.com

TRAILER COMMERCIAL VEHICLE SYSTEMS

2070 Industrial Place SE
Canton, OH 44707-2641 USA
866.RIDEAIR (743.3247)
330.489.0045 • Fax 800.696.4416

Hendrickson Canada

250 Chrysler Drive, Unit #3
Brampton, ON Canada L6S 6B6
800.668.5360
905.789.1030 • Fax 905.789.1033

Hendrickson Mexicana

Circuito El Marqués Sur #29
Parque Industrial El Marqués
Pob. El Colorado, Municipio El Marqués,
Querétaro, México C.P. 76246
+52 (442) 296.3600 • Fax +52 (442) 296.3601

L720 Rev D 04-19

© 1999 – 2019 Hendrickson USA, L.L.C. All Rights Reserved. All trademarks shown are owned by Hendrickson USA, L.L.C., or one of its affiliates, in one or more countries.
Information contained in this literature was accurate at the time of publication. Product changes may have been made after the copyright date that are not reflected.

Printed in United States of America