

TECHNICAL PROCEDURE

TRAILER SUSPENSION SYSTEMS

SUBJECT: Recommended Ride Height Settings

LIT NO: L388

DATE: December 2014

REVISION: G

The tables in this publication list the recommended or “designed” ride heights for all current Hendrickson trailer suspensions. The designed ride height helps optimize suspension performance and helps maintain load equalization among the axles.

NOTE: Ride height is just one of many factors that influence load equalization. Even small adjustments in ride height (within the specified range) can impact the way the load is distributed among the axles.

Operating an air suspension outside its specified ride height range can reduce ride quality, damage cargo and increase suspension wear. To take full advantage of the benefits an air-ride suspension has to offer, each suspension on the trailer should be operated at its designed ride height.

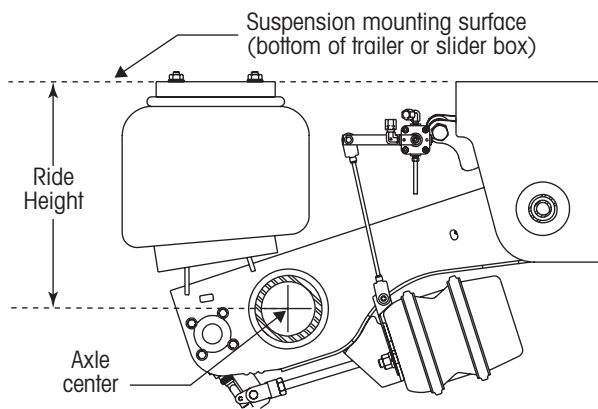

Figure 1: Ride height defined

A suspension’s designed ride height is defined as the distance from the suspension mounting surface (the bottom of the trailer frame or slider box) to the center of the axle. See [Figure 1](#).

There are two easy ways to determine a suspension’s ride height:

I. USING A HENDRICKSON RIDE HEIGHT GAUGE

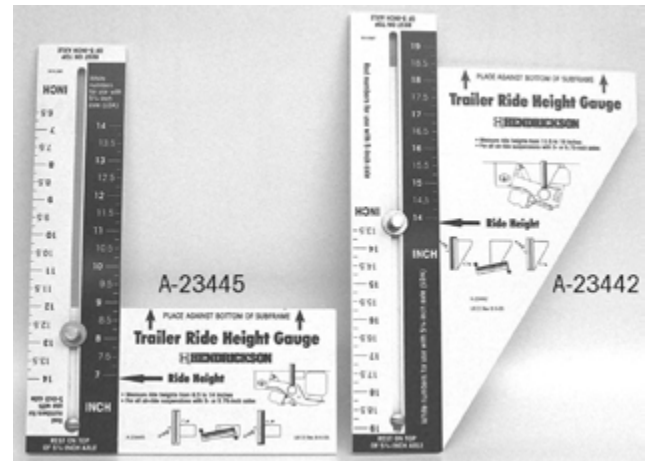

Figure 2: Hendrickson ride height gauges

Follow instructions on the gauge to measure the distance between the axle and the mounting surface of the suspension. A ride height gauge, shown in [Figure 2](#), works with both 5-inch and large diameter axles (LDA™). Just make sure you are using the proper scale on the ride height gauge. The tool can also be used as a GO/NO-GO gauge.

NOTE: To order a Ride Height Gauge, contact the Hendrickson customer service department at 866.RIDEAIR (743.3247) and specify part number A-23442 (Ride Height Gauge for conventional top-mount suspensions) or A-23445 (Ride Height Gauge for low-ride suspensions).

II. USING A TAPE MEASURE

1. **Measure** the distance from the top of the axle to the mounting surface of the suspension ([Figure 3](#)).
2. **Add** half of the axle diameter to this measurement to determine your suspension’s ride height.

RECOMMENDED RIDE HEIGHT SETTINGS



For example: on 5-inch axles, add 2½ (2.5) inches to the measured distance, and on LDA™ Large Diameter Axle, add 2⅞ (2.88) inches to the measured distance.

3. **Compare** this measured ride height with the listing in the appropriate table (see [page 3](#) through [page 12](#)).

NOTE: While we recommend that our suspensions operate at their designed ride height, they can be satisfactorily operated within the range listed in the table applicable to your suspension model or type.

If the measured ride height does not fall within the range listed in the table, the suspension's ride height must be adjusted. Refer to Hendrickson publication [L459 Checking Trailer Ride Height](#), for complete ride height adjustment instructions.

If your suspension model number is not listed in the tables, contact the Hendrickson technical service department in the United States and Canada at 866.RIDEAIR (743.3247) for ride height range information.

DESIGNED RIDE HEIGHT AND SURELOK®

SURELOK® is a ride height locking device that uses mechanical support arms to maintain the trailer's height for efficient trailer loading. When engaged, the mechanical support arms help limit trailer "drop" and "walk" during the loading/unloading process.

NOTE: Refer to Hendrickson publications [L816, DOCK SOLUTIONS](#) or [T15001, TRAILER AIR SUSPENSIONS CONCEPT AND FUNCTIONS](#) for a complete description of trailer drop and walk.

If a suspension is equipped with SURELOK, it should be operated as close as possible to its designed ride height. Suspension ride height is the primary consideration for optimal SURELOK performance (not the amount of clearance between the SURELOK support arms and the suspension beam). When the suspension is operated at its designed ride height, the SURELOK support arms will have the proper clearance from the suspension beams.

Any increase above the specified maximum ride height can reduce the effectiveness of SURELOK to limit trailer drop and/or walk. See [Figure 4](#). Conversely, any ride height set below the specified minimum ride height

value will prevent the SURELOK support arms from properly engaging. See [Figure 5](#).

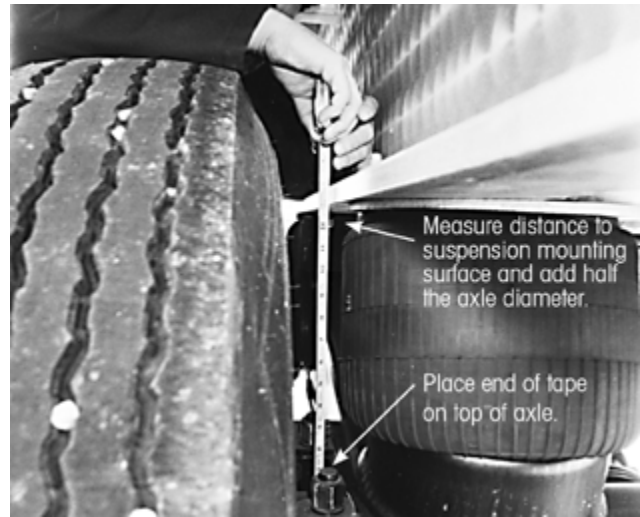

Figure 3: Measuring ride height using tape measure

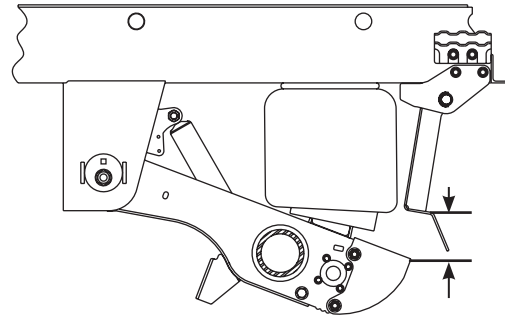

Figure 4: Ride height set too high

- A. If ride height is set **above specified maximum** value ([Figure 4](#)), The trailer has the potential to exhibit excessive "walk" and/or drop before the SURELOK support arms can contact the beam and maintain trailer height.

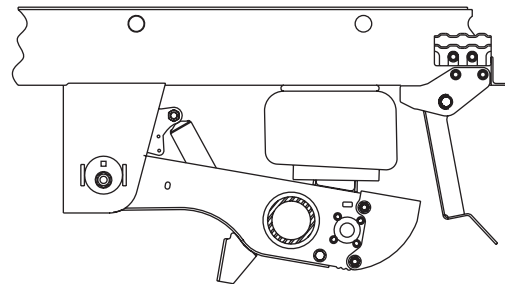

Figure 5: Ride height set too low

- B. If ride height is set **below specified minimum** value ([Figure 5](#)), The SURELOK support arms (shown in retracted position) cannot contact properly engage the beam.



RECOMMENDED RIDE HEIGHT SETTINGS

INTRAAX® AANT 23K, AAT 23K, AAT 25K, AAZNT 23K, AAZNT 46K & AAZNT 69K RIDE HEIGHT SETTINGS*

SUSPENSION TYPE	DESIGNED RIDE HEIGHT	MINIMUM RIDE HEIGHT	MAXIMUM RIDE HEIGHT
STANDARD	12"	11.75"	13"
	13.5"	13.25"	15.75"
	14"	13.25"	15.75"
	15"	14.25"	15.75"
	16"	15.25"	17.75"
	17"	16.25"	17.75"
	18" ¹	17.25"	19.75"
	19"	18.25"	19.75"
HIGH CONTROL	13.5"	13.5"	16"
	14"	13.5"	16"
	15"	14.5"	16"
	16"	15.5"	18.5"
	17"	16.5"	18.5"
LIMITED JOUNCE	14"	13.25"	14.5"
	16"	15.25"	16.5"
LIMITED REBOUND	14"	13.25"	14.5"
	16"	15.25"	16.5"
	18"	17.25"	18.5"

¹ Ride height not available on AANT 23K models.

INTRAAX® AANL 23K RIDE HEIGHT SETTINGS

SUSPENSION TYPE	DESIGNED RIDE HEIGHT	MINIMUM RIDE HEIGHT	MAXIMUM RIDE HEIGHT
STANDARD	6.5" ¹	6.5" ¹	8" ¹
	7.5" ¹	6.5" ¹	8" ¹
	8" ¹	7.5" ¹	10" ¹
	9"	7.5"	10"
	12"	10"	13"
	14"	11.5"	15"
	15"	12.75"	15"
	16"	13.75"	17"
	17"	14.5"	17"
LIMITED JOUNCE	8"	8"	10"
	9"	8.5"	10"
	12"	11"	13.5"
	14"	12.5"	15"
	15"	13.5"	15"
	16"	14.5"	17"
	17"	15.5"	17"

¹ Ride height not available on AANT 23K models.

* If any of these suspensions are equipped with SURELOK®, they should be operated as close as possible to the designed ride height. Refer to the section titled DESIGNED RIDE HEIGHT AND SURELOK® on page 2 for details on how an improper ride height can reduce the effectiveness of SURELOK to limit trailer drop and/or walk, or prevent the SURELOK support arms from properly engaging.



INTRAAX® AAT 23K, AAT 25K & AAT 30K LARGE DIAMETER AXLE RIDE HEIGHT SETTINGS*

SUSPENSION TYPE	DESIGNED RIDE HEIGHT	MINIMUM RIDE HEIGHT	MAXIMUM RIDE HEIGHT
STANDARD	13.5"	13.25"	15.75"
	14"	13.25"	15.75"
	15"	14.25"	15.75"
	16"	15.25"	17.75"
	17"	16.25"	17.75"
	18"	17.25"	19.75"
	19"	18.25"	19.75"
HIGH CONTROL	13.5"	13.5"	16"
	14"	13.5"	16"
	15"	14.5"	16"
	16"	15.5"	18.5"
	17"	16.5"	18.5"
LIMITED REBOUND	14"	13.25"	14.5"
	16"	15.25"	16.5"
	18"	17.25"	18.5"
LIMITED JOUNCE	14"	14"	15.75"
	15"	15"	15.75"
	16"	16"	17.75"
	17"	17"	17.75"

INTRAAX® AAT 30K RIDE HEIGHT SETTINGS*

SUSPENSION TYPE	DESIGNED RIDE HEIGHT	MINIMUM RIDE HEIGHT	MAXIMUM RIDE HEIGHT
STANDARD	13.5"	13.25"	15.75"
	14"	13.25"	15.75"
	15"	14.25"	15.75"
	16"	15.25"	17.75"
	17"	16.25"	17.75"
	18"	17.25"	19.75"
	19"	18.25"	19.75"
HIGH CONTROL	13.5"	13.5"	16"
	14"	13.5"	16"
	15"	14.5"	16"
	16"	15.5"	18.5"
	17"	16.5"	18.5"

* If any of these suspensions are equipped with SURELOK®, they should be operated as close as possible to the designed ride height. Refer to the section titled DESIGNED RIDE HEIGHT AND SURELOK® on page 2 for details on how an improper ride height can reduce the effectiveness of SURELOK to limit trailer drop and/or walk, or prevent the SURELOK support arms from properly engaging.

**INTRAAX® AAEDT 30K RIDE HEIGHT SETTINGS**

SUSPENSION TYPE	DESIGNED RIDE HEIGHT	MINIMUM RIDE HEIGHT	MAXIMUM RIDE HEIGHT
STANDARD (FRONT SHOCKS)	14"	13.75"	15.25"
	15"	14.5"	15.75"
	16"	15.25"	17.75"
	17"	15.25"	17.75"
STANDARD (REAR SHOCKS)	14"	13.75"	14.75"
	15"	14.5"	15.5"
	16"	15.25"	17.5"
	17"	15.25"	17.5"

INTRAAX® AANLS 20K RIDE HEIGHT SETTINGS

SUSPENSION TYPE	DESIGNED RIDE HEIGHT	MINIMUM RIDE HEIGHT	MAXIMUM RIDE HEIGHT
STANDARD	6.25"	6.25"	8"
	7"	6.25"	8"
	9"	8"	9.5"
	12"	10.5"	12"

INTRAAX® AAL 23K, AAL 25K, AAL 30K, AAEDL 30K AAZL 23K & AAZL 46K RIDE HEIGHT SETTINGS

SUSPENSION TYPE	DESIGNED RIDE HEIGHT	MINIMUM RIDE HEIGHT	MAXIMUM RIDE HEIGHT
STANDARD	6.5" ¹	6.5" ¹	7.5" ¹
	7.5" ¹	6.5" ¹	7.5" ¹
	8" ¹	7.25" ¹	10" ¹
	9"	7.25"	10"
	12"	10"	13.5"
	14"	11.25"	15"
	15"	12.75"	15"
	16"	13.5"	17"
	17"	14.25"	17"
	19"	16.5"	19"
21"	18.5"	21"	
LIMITED JOUNCE	9"	8.5"	10"
	12"	11"	13.5"
	14"	12.5"	15"
	15"	13.5"	15"
	16"	14.5"	17"
	17"	15.5"	17"
	19"	17.5"	19"
21"	19.25"	21"	

¹ Ride height not available on AANT 23K models.



HT190 RIDE HEIGHT SETTINGS

SUSPENSION MODEL NUMBER	DESIGNED RIDE HEIGHT	MINIMUM RIDE HEIGHT	MAXIMUM RIDE HEIGHT
Underslung Primary Fixed Suspensions			
HT190UB6-020	6"	6"	8.25"
HT190UB7-001	7"	7"	8.25"
HT190UB7.5-001	7.5"	7.25"	8.75"
HT190UB9-001	9"	8.75"	10.25"
HT190UB12-001	12"	11.75"	12.75"
Top Mount Primary Fixed Suspensions*			
HT190TA14-005	14"	14"	15.25"
HT190TA15-005	15"	14.75"	16.25"
HT190TA16-005	16"	16"	17"
HT190TA17-005	17"	16.75"	18.25"
HK Slider Suspensions (HT190T Suspension on K-2® Slider Box)*			
HK190T-16	16"	15.75"	16.25"
HK190T-16.5	16.5"	16.5"	16.75"
HK190T-17	17"	16.75"	17.25"
HK190T-18	18"	17.75"	18.25"
HK190T-19	19"	18.75"	19.25"
HK RAMP-READY SLIDER Suspensions (HT200U Suspension on K-2 RAMP-READY SLIDER Box)			
HTHCR200U9	9"	8.75"	10"
HTHCR200U10	10"	9.75"	11"
HTHCR200U11	11"	10.75"	12.5"
HTHCR200U12	12"	11.75"	12.5"
HT190TA Suspensions on Non-Hendrickson Slider Box*			
HT190TA14-001	14"	14"	15"
HT190TA15-001	15"	14.75"	16.25"
HT190TA16-001	16"	16"	17"
HT190TA17-001	17"	16.75"	18.25"

* If any of these suspensions are equipped with SURELOK®, they should be operated as close as possible to the designed ride height. Refer to the section titled DESIGNED RIDE HEIGHT AND SURELOK® on page 2 for details on how an improper ride height can reduce the effectiveness of SURELOK to limit trailer drop and/or walk, or prevent the SURELOK support arms from properly engaging.

**HT230 RIDE HEIGHT SETTINGS**

SUSPENSION MODEL NUMBER	DESIGNED RIDE HEIGHT	MINIMUM RIDE HEIGHT	MAXIMUM RIDE HEIGHT
Primary Fixed Suspensions*			
HT230TA14-001, -002, & -007	14"	14"	16"
HT230TA15-001, -002, & -007	15"	15"	17"
HT230TA16-001, -002 & -007	16"	16"	17.75"
HT230TA17-001, 002, & -007	17"	17"	19"
HT230TA19-001 HT230TB19-001	19"	19"	20.75"
HK Slider Suspensions (HT230 Suspension on K-2® Slider Box)*			
HK230-16	16"	15.75"	16.25"
HK230-16.5	16.5"	16.5"	16.75"
HK230-17	17"	16.75"	17.25"
HK230-18	18"	17.75"	18.25"
HK230-19	19"	18.75"	19.25"
HT230 Suspensions on Non-Hendrickson Slider Box*			
HT230TA14-004 HT230TB14-003	14"	14"	15.75"
HT230TA15-009 HT230TB15-009 HT230TB15-010	15"	15"	16.75"
HT230TA16-004 HT230TB16-003 HT230TB16-004	16"	16"	17.75"
HT230TB17-009 HT230TB17-010	17"	17"	18.75"
Liftable Suspensions			
HT230TB15-003	15"	14.25"	16"
HT230TB17-003	17"	16"	18"

* If any of these suspensions are equipped with SURELOK®, they should be operated as close as possible to the designed ride height. Refer to the section titled DESIGNED RIDE HEIGHT AND SURELOK® on page 2 for details on how an improper ride height can reduce the effectiveness of SURELOK to limit trailer drop and/or walk, or prevent the SURELOK support arms from properly engaging.



HT250 RIDE HEIGHT SETTINGS

SUSPENSION MODEL NUMBER	DESIGNED RIDE HEIGHT	MINIMUM RIDE HEIGHT	MAXIMUM RIDE HEIGHT
Underslung Primary Fixed Suspensions			
HT250UB7.5-DB1	7.5"	7.0"	9.75"
HT250UB9-DB1	9"	7.0"	9.75"
Top Mount Liffable Fixed Suspensions ^{*.1}			
HT250TB12-001	12"	11.75"	14.5"
HT250TB14-001	14"	11.75"	14.5"
HT250TB15-001	15"	13"	15"
HT250TB16-001	16"	14"	16"
HT250TB17-001	17"	15"	17"
HT250TB19-001	19"	16"	19"
Underslung Y-Beam Suspensions			
HT250YS-6.5-001	6.5"	6.25"	8.0"
HT250YS-7.5-001	7.5"	6.75"	9.0"
HT250YS-9-001	9"	7.25"	10.5"
HT250YB-7.5-DB1	7.5"	7.5"	10.0"
HT250YB-9-DB1	9"	8"	10.0"
¹ The HT250T is intended for use as a liffable suspension, in combination with other HT primary fixed suspension models.			

* If any of these suspensions are equipped with SURELOK[®], they should be operated as close as possible to the designed ride height. Refer to the section titled DESIGNED RIDE HEIGHT AND SURELOK[®] on page 2 for details on how an improper ride height can reduce the effectiveness of SURELOK to limit trailer drop and/or walk, or prevent the SURELOK support arms from properly engaging.



HT250US RIDE HEIGHT SETTINGS

SUSPENSION TYPE	DESIGNED RIDE HEIGHT	MINIMUM RIDE HEIGHT	MAXIMUM RIDE HEIGHT
STANDARD	3.5"	3.5"	3.75"
	4"	4"	4"
	5.5"	5.5"	7"
	6.5"	6.5"	7"
	7.5"	7.5"	10.75"
	9"	7.5"	10.75"
	12"	10.25"	13.25"
	14"	12.25"	15.25"
STEERABLE	7.5"	7.5"	10.75"
	9"	8.25"	10.75"
	12"	10.75"	13.25"
	14"	12.25"	15.25"
LIMITED JOUNCE	3.5"	3.5"	3.5"
	6.5"	6.5"	10.75"
	7.5"	7.5"	10.75"
	9"	9"	10.75"
	12"	12"	15.25"
EXTENDED REBOUND	6.5"	6.5"	8.5"
	7.5"	7.5"	10.0"
	9"	7.5"	10.25"

HT300T RIDE HEIGHT SETTINGS

SUSPENSION MODEL NUMBER	DESIGNED RIDE HEIGHT	MINIMUM RIDE HEIGHT	MAXIMUM RIDE HEIGHT
Top Mount Primary Fixed Suspensions - Standard			
HT300TB15-001	15"	14.75"	16.25"
HT300TB17-001	17"	16.75"	18.25"
HT300TB19-001	19"	18"	19"
Top Mount Primary Fixed Suspensions - Liftable			
HT300TB17-003	17"	15.75"	17.75"
HT300T19-001	19"	18"	19"



HT300US RIDE HEIGHT SETTINGS

SUSPENSION TYPE	DESIGNED RIDE HEIGHT	MINIMUM RIDE HEIGHT	MAXIMUM RIDE HEIGHT
STANDARD	5.5"	5.5"	7.0"
	6.5"	6.5"	7.0"
	7.5"	7.5"	10.5"
	9"	7.75"	10.5"
	12"	10.5"	13"
	14"	12"	15"
	17"	14.5"	17.5"
LIMITED JOUNCE	6.5"	6.5"	7.0"
	7.5"	7.5"	10.5"
	9"	8.75"	10.5"
	12"	11.25"	13"
	14"	13.25"	15"
	17"	15.5"	17.5"
EXTENDED REBOUND	6.5"	6.5"	8.5"

HK190 / HK230 RIDE HEIGHT SETTINGS*

SUSPENSION TYPE	DESIGNED RIDE HEIGHT	MINIMUM RIDE HEIGHT	MAXIMUM RIDE HEIGHT
STANDARD	16"	15.75"	16.25"
	16.5"	16.5"	16.75"
	17"	16.75"	17.25"
	18"	17.75"	18.25"
	19"	18.75"	19.25"



VANTRAA[®] HKA 18K, HKA 20K AND HKANT 40K RIDE HEIGHT SETTINGS*

SUSPENSION TYPE	DESIGNED RIDE HEIGHT	MINIMUM RIDE HEIGHT	MAXIMUM RIDE HEIGHT
STANDARD	14"	13.75"	15.25"
	15"	14.75"	15.25"
	16"	16"	17.25"
	16.5"	16.5"	17.25"
	17"	17"	17.25"
	18"	18"	19.25"
	19"	19"	19.25"

VANTRAA[®] HKANT 23K AND 46K RIDE HEIGHT SETTINGS*

SUSPENSION TYPE	DESIGNED RIDE HEIGHT	MINIMUM RIDE HEIGHT	MAXIMUM RIDE HEIGHT
49" AXLE SPACING	16"	16"	18"
	17"	17"	18"
121" AXLE SPACING	16"	16"	17.25"
	17"	17"	17.25"

VANTRAA[®] HKAT 46K RIDE HEIGHT SETTINGS*

SUSPENSION TYPE	DESIGNED RIDE HEIGHT	MINIMUM RIDE HEIGHT	MAXIMUM RIDE HEIGHT
STANDARD	14"	13.75"	15.75"
	15"	14.75"	15.75"
	16"	16"	17.75"
	16.5"	16.5"	17.75"
	17"	17"	17.75"
	18"	18"	19.75"
	19"	19"	19.75"

VANTRAA[®] HKARL 46K (RAMP-READY SLIDER) & HKAL 46K RIDE HEIGHT SETTINGS

SUSPENSION TYPE	DESIGNED RIDE HEIGHT	MINIMUM RIDE HEIGHT	MAXIMUM RIDE HEIGHT
STANDARD	9"	8.5"	11.5"
	10"	9.5"	11.5"
	11"	10.5"	12"
	12"	11.5"	12"

* If any of these suspensions are equipped with SURELOK[®], they should be operated as close as possible to the designed ride height. Refer to the section titled DESIGNED RIDE HEIGHT AND SURELOK[®] on page 2 for details on how an improper ride height can reduce the effectiveness of SURELOK to limit trailer drop and/or walk, or prevent the SURELOK support arms from properly engaging.

VANTRAA[®] HKANL 23K RIDE HEIGHT SETTINGS

SUSPENSION TYPE	DESIGNED RIDE HEIGHT	MINIMUM RIDE HEIGHT	MAXIMUM RIDE HEIGHT
STANDARD	16" & 17"	14"	17"

VANTRAA[®] HKA 25K AND HKAT 50K RIDE HEIGHT SETTINGS*

SUSPENSION TYPE	DESIGNED RIDE HEIGHT	MINIMUM RIDE HEIGHT	MAXIMUM RIDE HEIGHT
STANDARD	16"	16"	17.5"
	16.5"	16.5"	17.5"
	17"	17"	17.5"
	18"	18"	19.75"
	19"	19"	19.75"

VANTRAA[®] HKANT & HKAT 69K23 RIDE HEIGHT SETTINGS*

SUSPENSION TYPE	DESIGNED RIDE HEIGHT	MINIMUM RIDE HEIGHT	MAXIMUM RIDE HEIGHT
STANDARD	16"	16"	17.5"
	16.5"	16.5"	17.5"
	17"	17"	17.5"
	18"	18"	19.5"

VANTRAA[®] HKAT 50K & 69K25 RIDE HEIGHT SETTINGS*

SUSPENSION TYPE	DESIGNED RIDE HEIGHT	MINIMUM RIDE HEIGHT	MAXIMUM RIDE HEIGHT
STANDARD	16"	16"	17.5"
	16.5"	16.5"	17.5"
	17"	17"	17.5"
	18"	18"	19.75"
	19" ¹	19"	19.75"

¹ Ride height not available on HKAT 69K25 models

ULTRAA-K[™] UTK 40K RIDE HEIGHT SETTINGS*

16" Ride height - No adjustments allowed.

* If any of these suspensions are equipped with SURELOK[®], they should be operated as close as possible to the designed ride height. Refer to the section titled DESIGNED RIDE HEIGHT AND SURELOK[®] on page 2 for details on how an improper ride height can reduce the effectiveness of SURELOK to limit trailer drop and/or walk, or prevent the SURELOK support arms from properly engaging.

Call your trailer dealer or Hendrickson at **866.RIDEAIR (743.3247)** for additional information.



www.hendrickson-intl.com

TRAILER COMMERCIAL VEHICLE SYSTEMS

2070 Industrial Place SE
Canton, OH 44707-2641 USA
866.RIDEAIR (743.3247)
330.489.0045 • Fax 800.696.4416

Hendrickson Canada

250 Chrysler Drive, Unit #3
Brampton, ON Canada L6S 6B6
800.668.5360
905.789.1030 • Fax 905.789.1033

Hendrickson Mexicana

Circuito El Marqués Sur #29
Parque Industrial El Marqués
Pob. El Colorado, Municipio El Marqués,
Querétaro, México C.P. 76246
+52 (442) 296.3600 • Fax +52 (442) 296.3601